

Ra 3,2 (✓)  $\begin{matrix} +0,2 \\ -0,3 \end{matrix}$

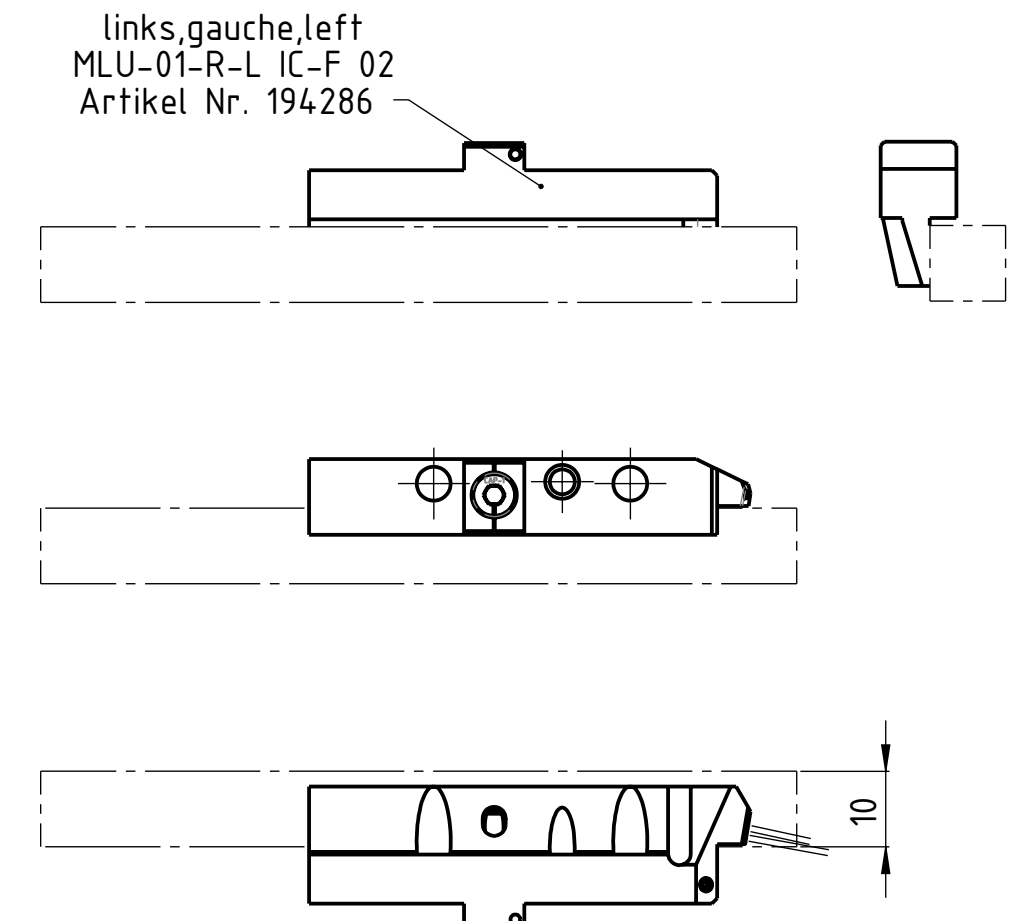

T2-T6 Standart Spannkeil

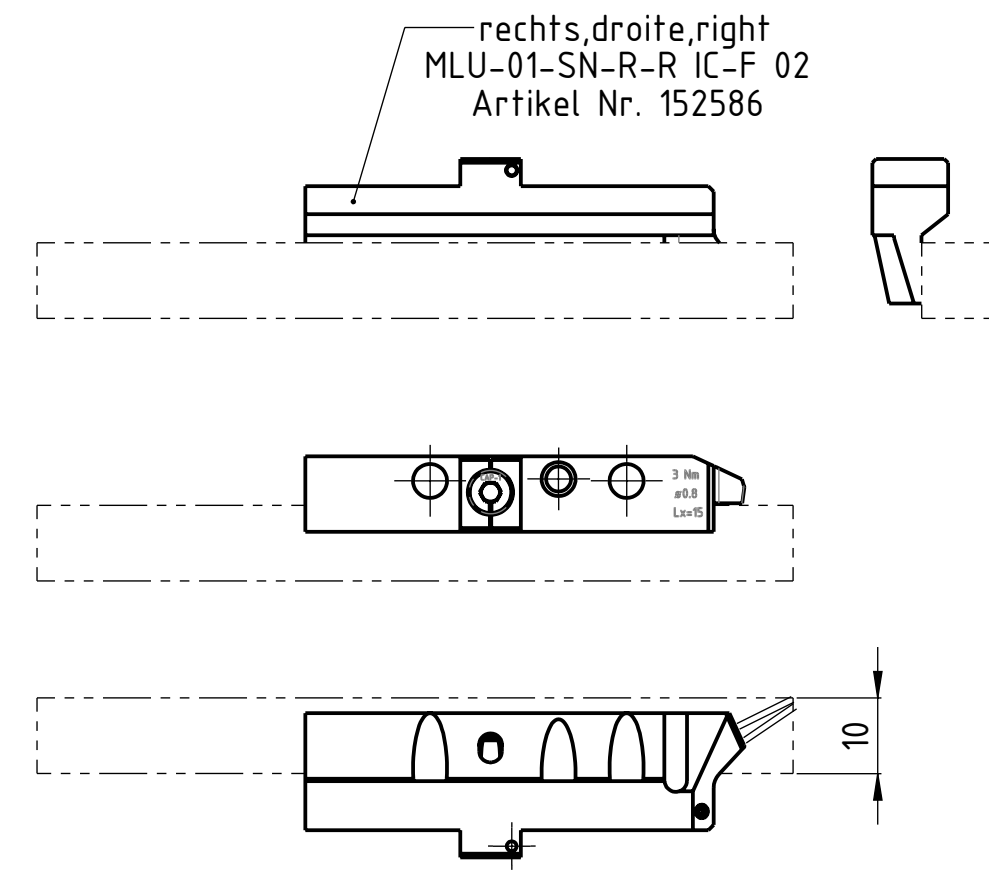
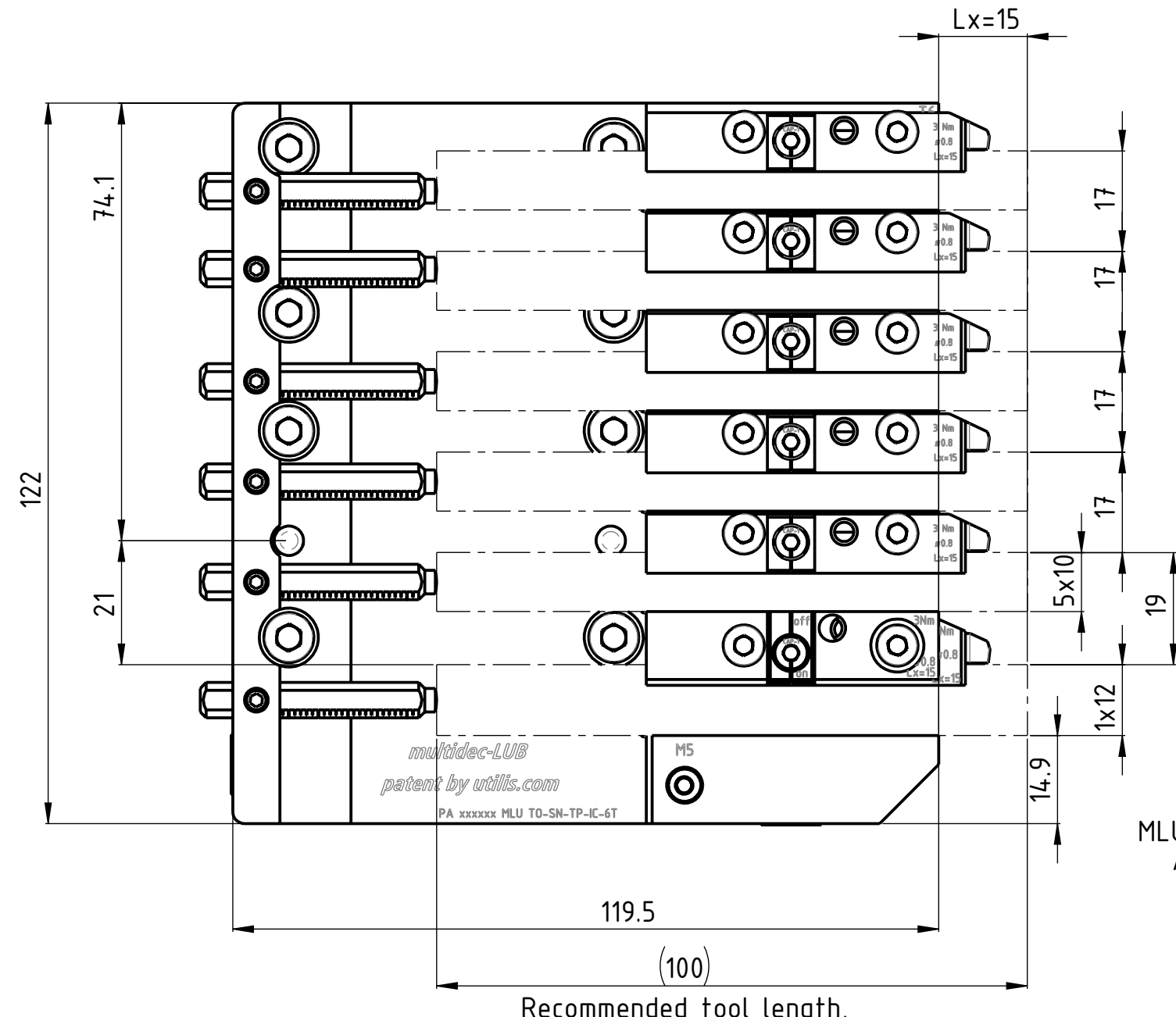
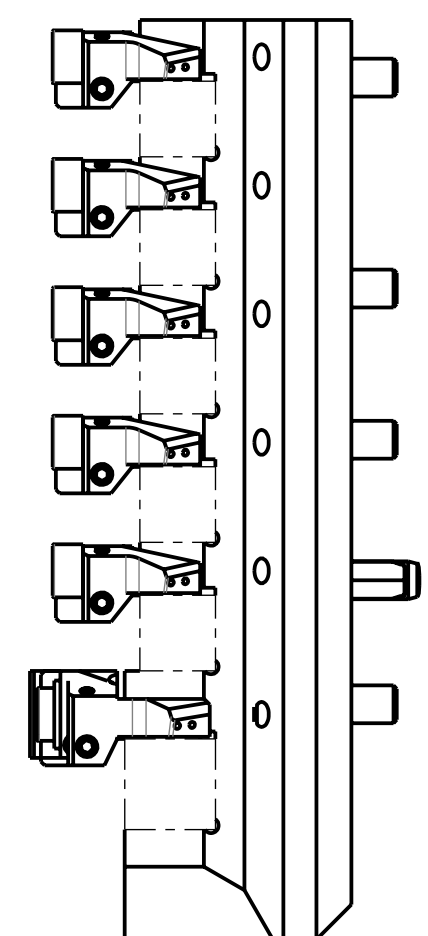
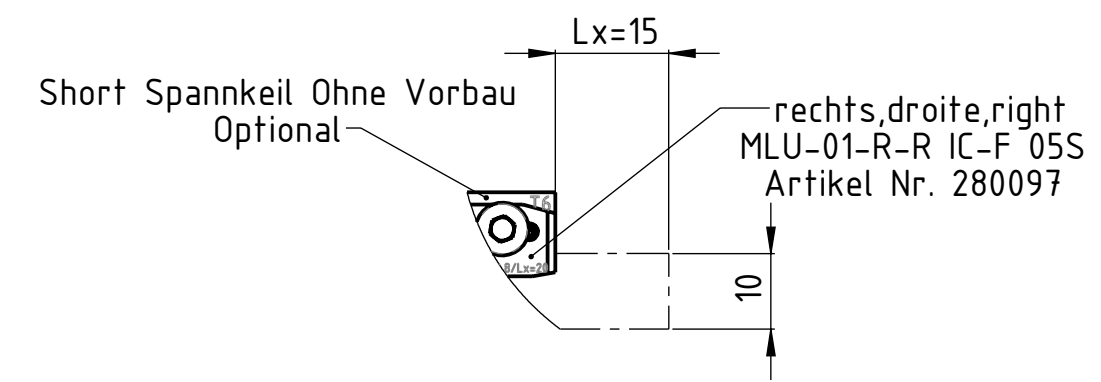
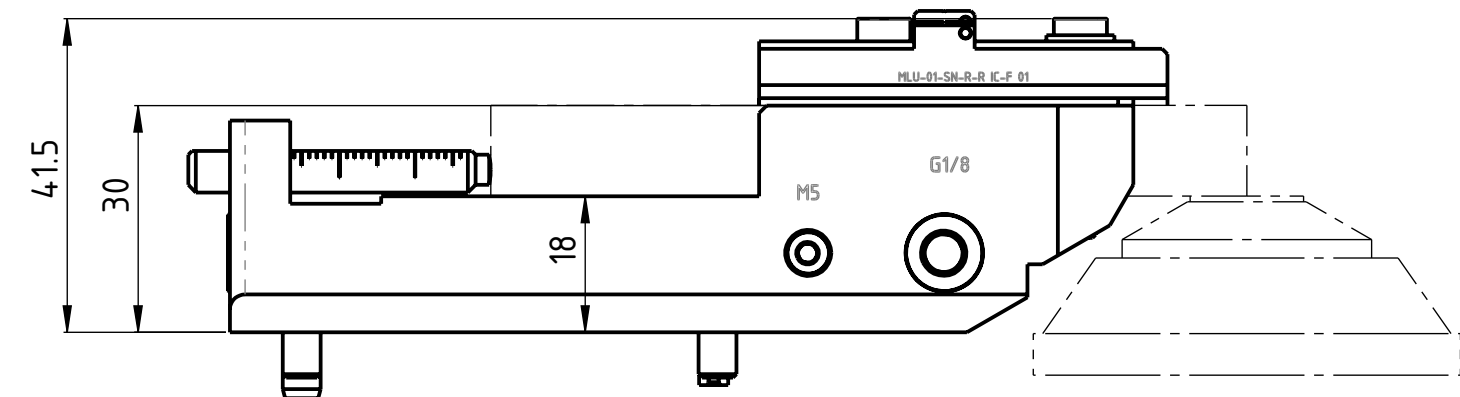
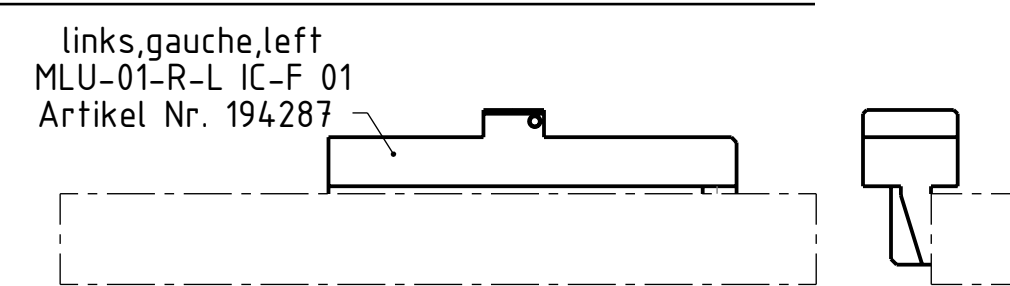
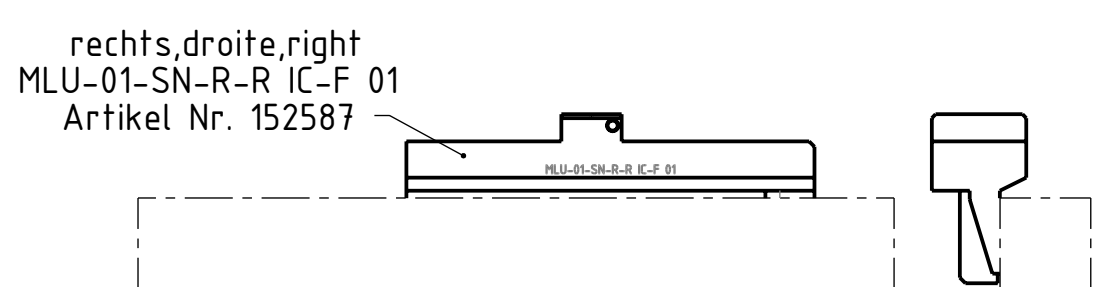

T1 Standart Spannkeil

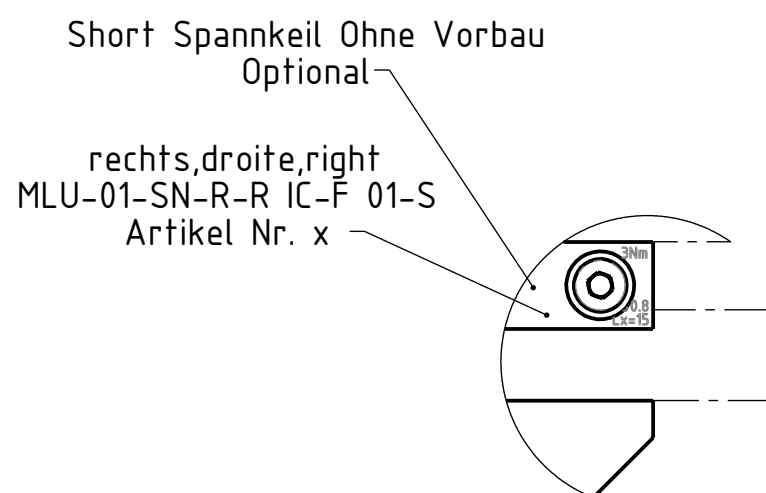
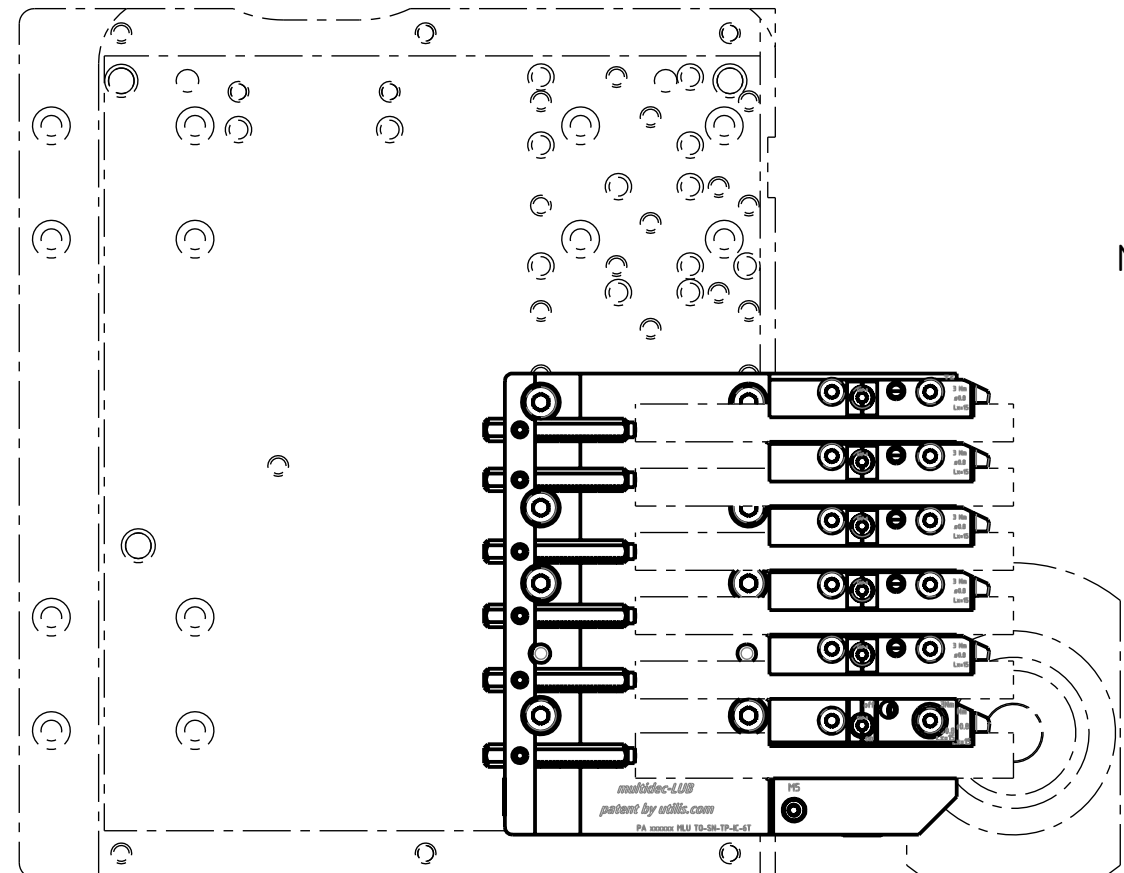

Lx= Vorstandlänge des Werkzeuges für optimale Kühlung  
Longueur d'outil pour un refroidissement optimal  
Tool length for optimal cooling

Recommended tool length, without insert TL = 100mm  
with insert ISO / TOP .. TL= 100mm  
with insert Cut 16 .. TL= 105mm  
with insert Cut 30 .. / 36... (short insert) TL = 111mm  
with insert Cut 30 .. (long insert) TL = 117mm